

Course & Distance  
Up the River

5° 65 E 9 ps

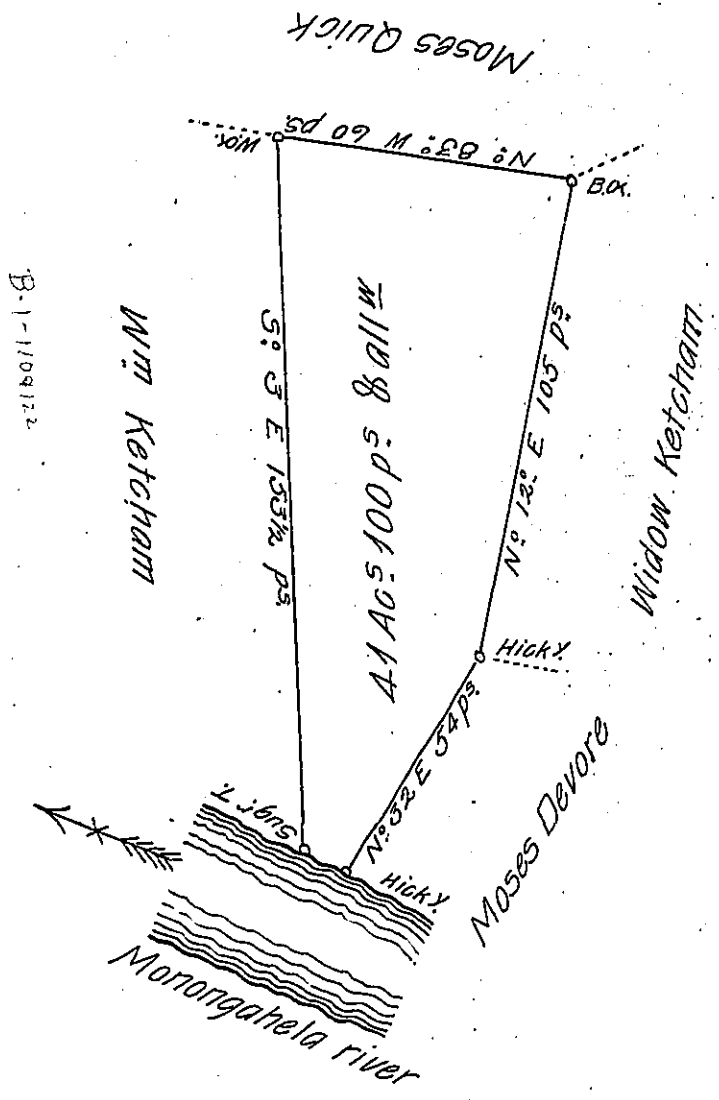

A Draught of a Survey called "Bellview" situate on the Monongahela river in Allegheny County, containing 4 1/2 Ac<sup>s</sup> 100 p<sup>s</sup> and the usual allow<sup>ce</sup> for roads & C. executed Decem<sup>r</sup> ye 8<sup>th</sup> 1802. in Pursuance of a Warrant granted to James Harriott for 35 Ac<sup>s</sup> dated March ye 12<sup>th</sup> 1802.

Presley Nevill D.S.

Samuel Cochran Esq<sup>r</sup> S<sup>r</sup> Gen!

IN TESTIMONY that the above is a copy of the original remaining on file in the Department of Internal Affairs of Pennsylvania, made conformably to an Act of Assembly approved the 16th day of February, 1833, I have hereunto set my Hand and caused the Seal of said Department to be affixed at Harrisburg, this fifteenth day of February 1905.

*Isaac R. Pearson*  
Secretary of Internal Affairs.